

REFERENCE:  
 BARBER/SMT - BOLSTER  
 POCKET WIDTH GAGE  
 TTX DRAWING B-10861 REV C

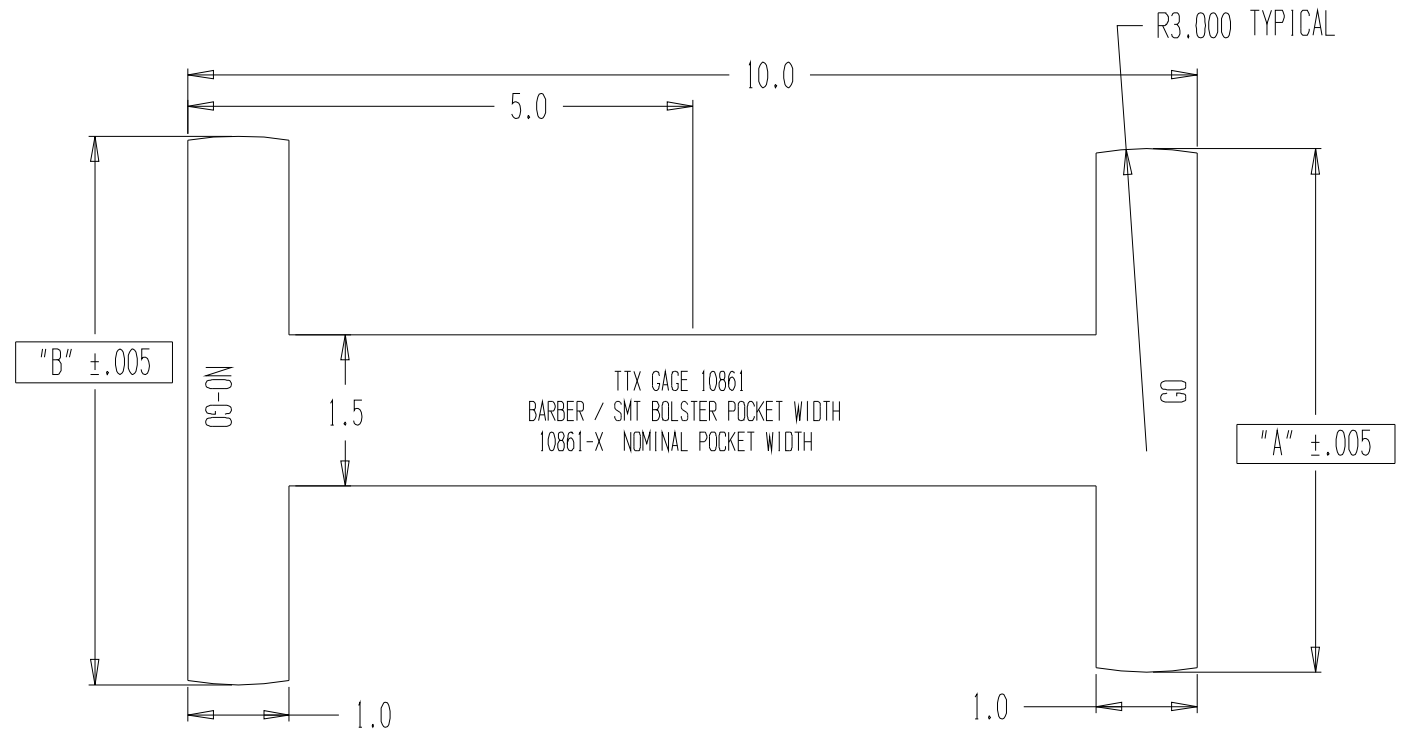

TTX #	GAGE #	"A"	"B"
-1	W374-1	5.188	5.438
-2	W374-2	5.688	5.938

Material:  
 Stainless Steel 17-7  
 Thickness: 3/16"

WINCHESTER INDUSTRIES INC.  
 POCKET WIDTH GAGE

SIZE A	Job#	DWG NO. W374	Disk	REV B
CUSTOMER			ENG DJD 02/18/2011	